

DS-KV8113-WME1(C) Video Intercom Villa Door Station



The KV8 series IP villa door station, designed with metal, supports multiple buttons to customize calling. Users can view, chat with, and send permission for the visitor via mobile phone in anywhere. The villa door station is powered by the standard PoE, and is no need to wire extra power supply, which is easy for installation and deployment. With high protective level, it is suitable for villa, detached house, etc.

- 2 MP camera with IR supplement
- One nametag button calling design for easier calls
- Built-in card reader module
- Standard PoE power supply
- IK08 & IP65 higher protection level with aluminum alloy material
- Convenient Hik-Connect APP mobile control

▪ Specification

System parameters	
Operation system	Linux
ROM	32 MB
RAM	256 MB
Processor	Embedded high performance processor
Display parameters	
Screen size	/
Operation method	/
Type	/
Resolution	/
Video parameters	
Lens	1
Resolution	Main stream:1920 × 1080p and 1280 × 720p Sub stream: 640 × 480p
FOV	Horizontal: 124° Vertical: 75°
Wide dynamic range (WDR)	Digital WDR/76.9 dB
Supplement light	IR light, up to 3 m
Video compression standard	H.264; h.265; MJPEG
Audio parameters	
Audio input	1 built-in omnidirectional microphone
Audio compression standard	G.711 U、 G.711 A、 Opus、 AAC-LD、 AAC-LC、 G.726、 G.722.1
Audio output	1 built-in loudspeaker
Audio compression bitrate	64 Kbps
Audio quality	Noise suppression and echo cancellation
Volume adjustment	Adjustable
Capacity	
User capacity	2000
Card capacity	10000
Linked indoor station capacity	1 (main indoor station)
Sub door station capacity	16
Network parameters	
Network protocol	TCP/IP, RTSP, ipv6, onvif
Wi-Fi	IEEE802.11b, IEEE802.11g, IEEE802.11n
Bluetooth	/
3G/4G	/
Received frequency	2.4 to 2.4835 GHz
Transmitted frequency	2.4 to 2.4835 GHz
Bandwidth	20/40 MHz
Frequency power	802.11b:15 dBm +/- 1.5 dBm 802.11g:15 dBm +/- 1.5 dBm 802.11n(ht20):14 dBm +/- 1.5 dBm 802.11n(ht40):12 dBm +/- 1.5 dBm
Authentication	
Card reading frequency	13.56 MHz

Device interfaces	
Alarm input	4
Network interface	1 RJ-45, 10/100 Mbps self-adaptive
TAMPER	1
Exit button	2
RS-485	1
USB	/
Wiegand	/
TF card	Reserved
Alarm output	/
Lock control	2 relays, Max. 30 VDC 2 A
Door contact input	2
General	
Button	1 physical button
Installation	Surface mounting
Indicator	3
Weight	Net weight: 0.370 kg Gross weight: 0.637 kg
Protective level	IP65, IK08
Working temperature	-40 °C to 53 °C (-40 °F to 127.4 °F)
Working humidity	10% to 95% (no-condensing)
Dimension (W × H × D)	174 mm × 91 mm × 29 mm (6.9" × 3.6" × 1.1")
Battery	/
Application environment	Outdoor
Power consumption	< 10 W
Language	English, Arabic, European French, Russian, European Spanish, Latin American Spanish, Italian, German, Polish, Turkish, Portuguese, Brazilian Portuguese, Uzbek, Kazakh, Czech, Hungarian, Dutch, Romanian, Bulgarian, Ukrainian, Croatian, Serbian, Greek, Lithuanian, Estonian, Latvian, Norwegian, Danish, Slovenian, Slovak, Hebrew, Swedish, Finnish, Mongolian, Vietnamese, Traditional Chinese (Taiwan), Latin American Spanish

▪ Available Model



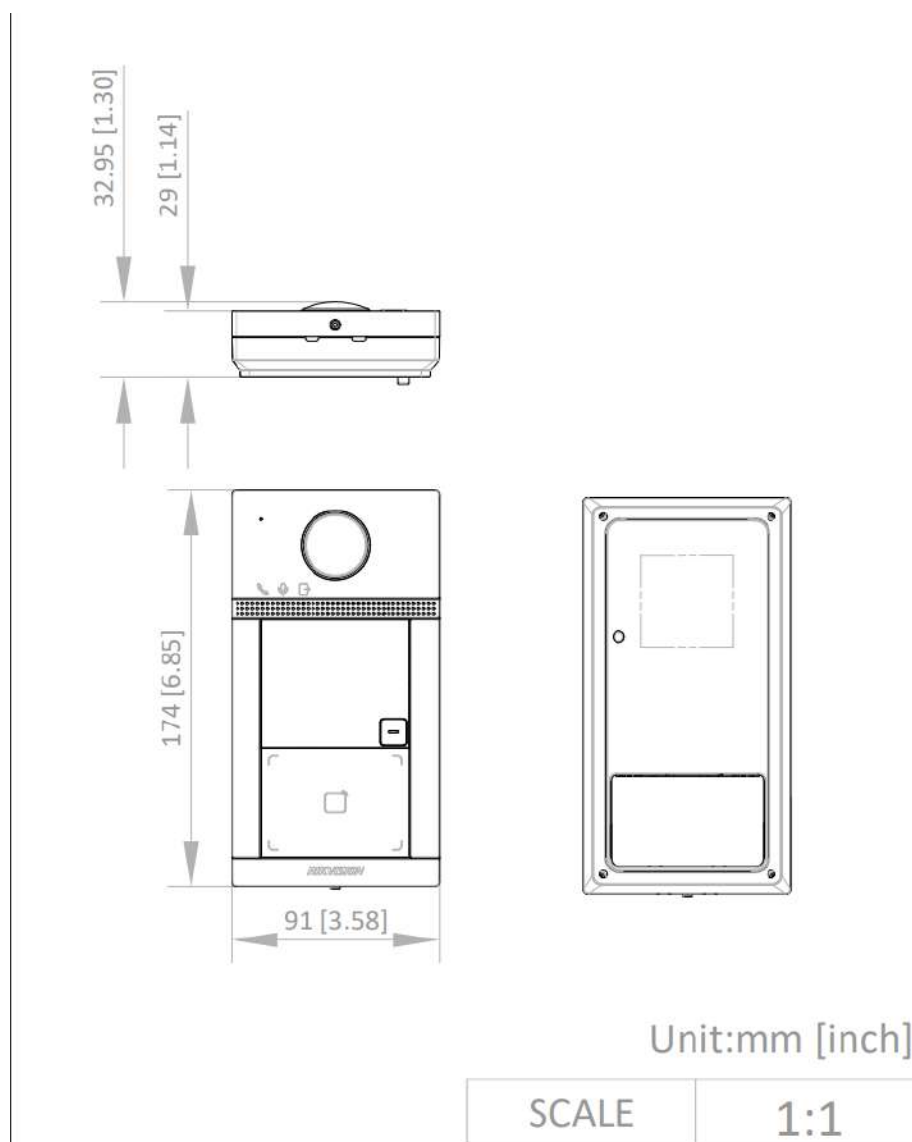

DS-KV8113-WME1(C)

▪ Dimension



▪ Accessory

▪ Optional

DS-KAW50-1	DS-KABV8113-RS/S urface	DS-KAW50-1N	DS-KABV8113-RS/F lush
			

See Far, Go Further



www.hikvision.com
support@hikvision.com

